

# INTERNATIONAL WOOD TRADE

## WOOD GLAZED OR OPAQUE DOUBLE DOOR

### INSWING/OUTSWING "NON-IMPACT"

#### GENERAL NOTES

1. This product has been evaluated and is in compliance with the 5th Edition (2014) Florida Building Code (FBC) structural requirements excluding the "High Velocity Hurricane Zone" (HVHZ).
2. Product anchors shall be as listed and spaced as shown on details. Anchor embedment to base material shall be beyond wall dressing or stucco.
3. When used in areas requiring wind borne debris protection, this product is required to be protected with an impact resistant covering that complies with Section 1609.1.2 of the FBC.
4. For 2x stud framing construction, anchoring of these units shall be the same as that shown for 2x buck masonry construction.
5. Site conditions that deviate from the details of this drawing require further engineering analysis by a licensed engineer or registered architect.

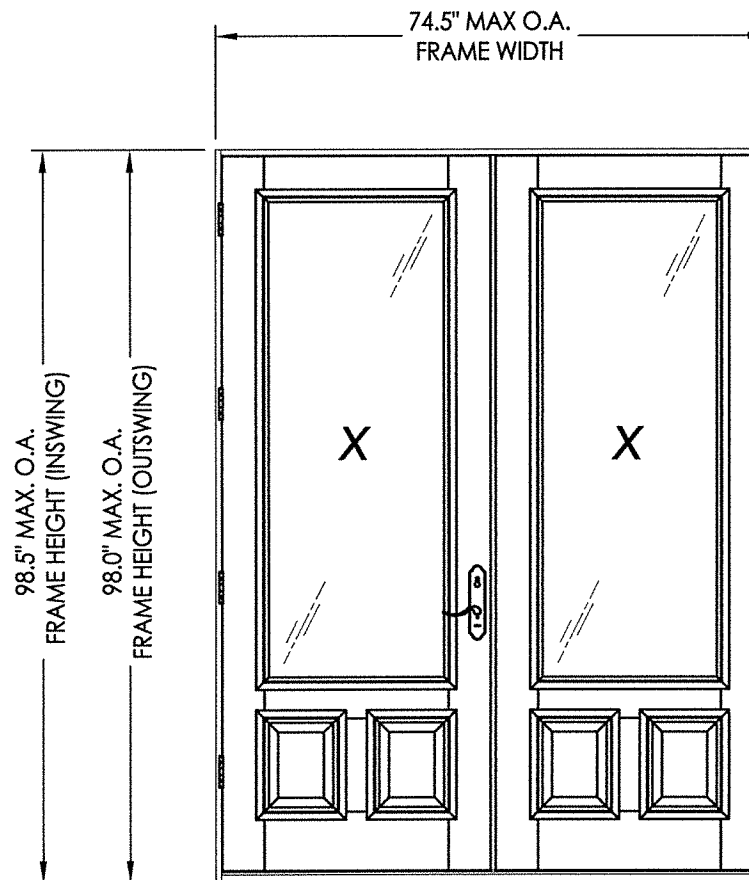
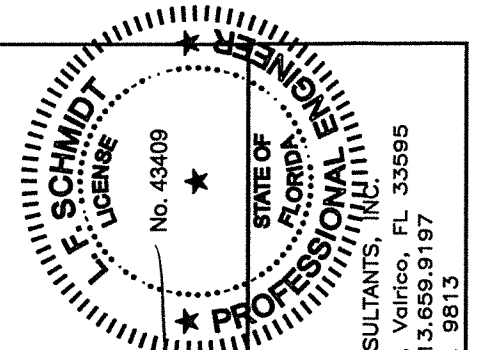

TABLE OF CONTENTS	
SHEET#	DESCRIPTION
1	Typical Elevations, Design Pressures & General Notes
2	Door Panel Details
3	Elevations
4	Horizontal & Vertical Cross Sections (2X Buck)
5	Horizontal & Vertical Cross Sections (1X Buck)
6	Horizontal & Vertical Cross Sections (Direct to Masonry)
7	Vertical Cross Sections (Thresholds)
8	Buck & Frame Anchoring
9	Hardware Details
10	Bill of Materials & Components

CONFIGURATION	LOCK HARDWARE	DESIGN PRESSURE (PSF) INSWING		DESIGN PRESSURE (PSF) OUTSWING	
		POSITIVE	NEGATIVE	POSITIVE	NEGATIVE
XX	Multipoint*	+55.0	-60.0	+55.0	-55.0

\*See Sheet 3 for Hardware Specifications



*LFS*  
8-24-16

Documents Prepared By:  
Lyndon F. Schmidt  
P.E. No. 43409  
*RW* BUILDING CONSULTANTS, INC.  
P.O. Box 230, Valrico, FL 33595  
Phone No.: 813.659.9197  
FBPE C.A. No. 9813

PRODUCT:  
INTERNATIONAL WOOD TRADE WOOD DOOR  
PART OR ASSEMBLY:  
TYPICAL ELEVATION, DESIGN PRESSURES & GENERAL NOTES

NO.	DATE	BY	REVISIONS

DATE: 8/10/16  
SCALE: N.T.S.  
DWG. BY: JK  
CHK. BY: LFS  
DRAWING NO.: FL-20800.6  
SHEET 1 of 10

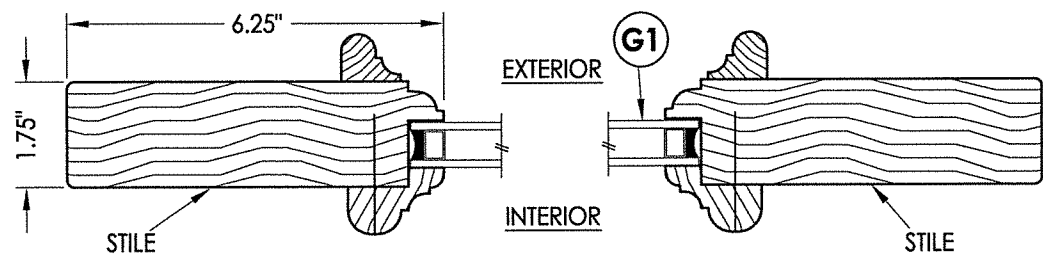

**1**  
**2** HORIZONTAL CROSS SECTION

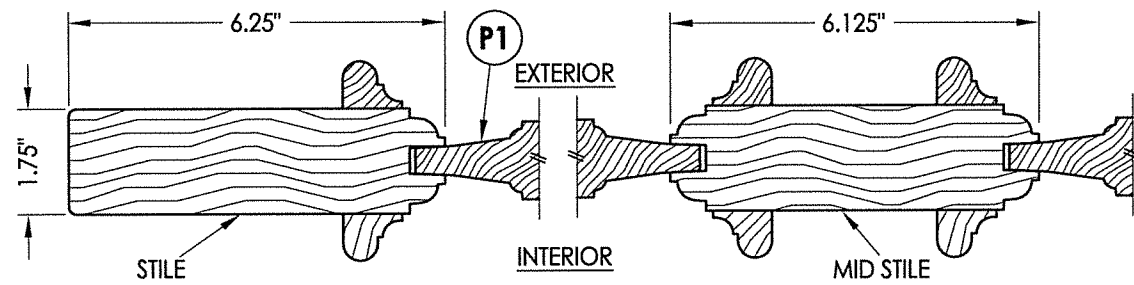

**2**  
**2** HORIZONTAL CROSS SECTION

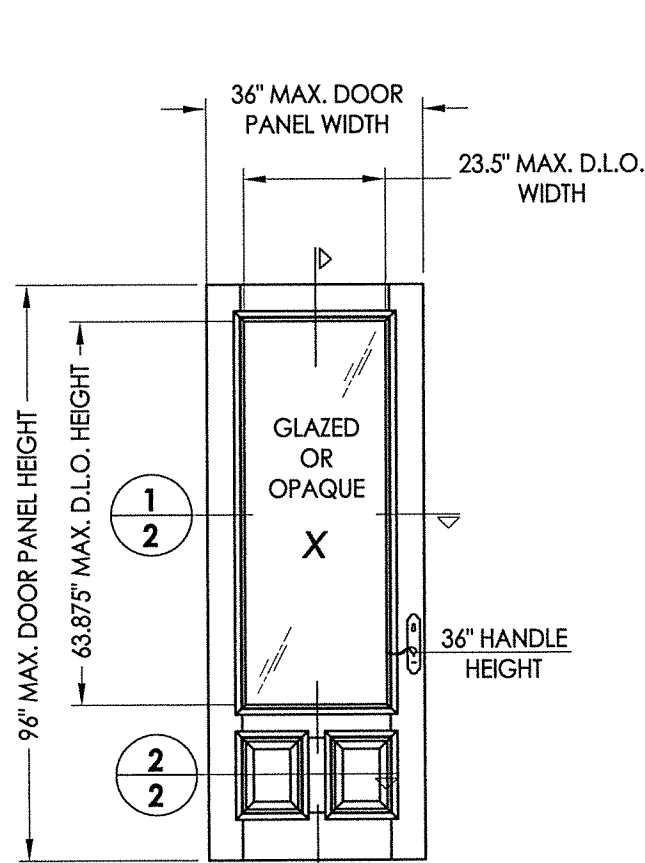

**40** WOOD DOOR PANEL  
Glazed or Opaque

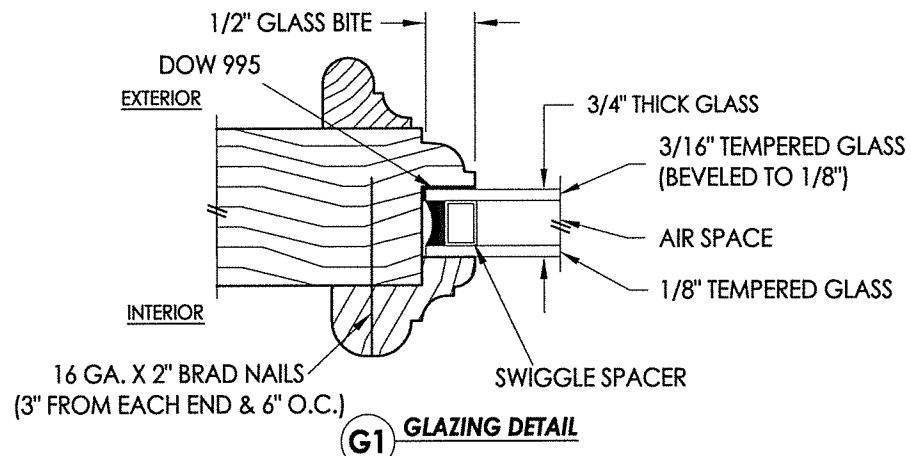

**G1** GLAZING DETAIL

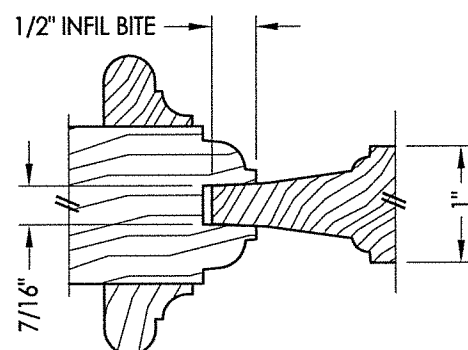

**P1** PANEL INFIL DETAIL

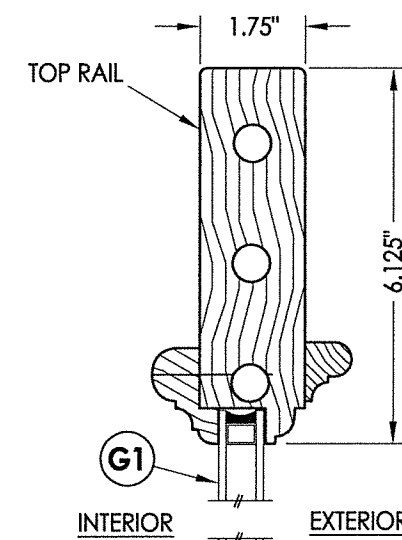

**3**  
**2** VERTICAL CROSS SECTION

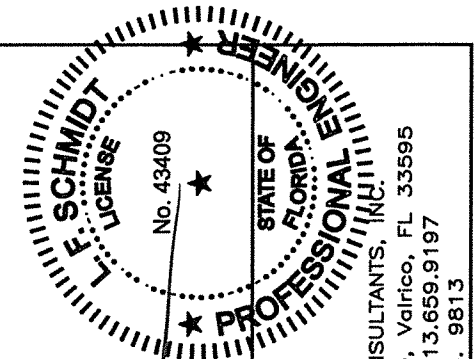
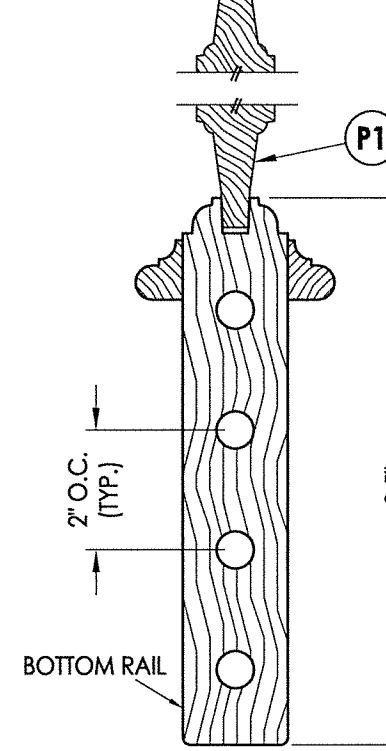
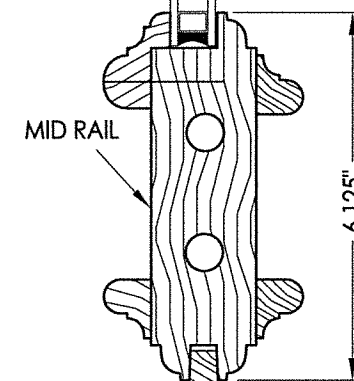

Documents Prepared By:  
Lyndon F. Schmidt  
P.E. No. 43409

*LFS*  
8-24-16

*RW* BUILDING CONSULTANTS, INC.  
P.O. Box 230, Valrico, FL 33595  
Phone No.: 813.659.9197  
FBPE C.A. No. 9813

PRODUCT:	INTERNATIONAL WOOD TRADE WOOD DOOR
PART OR ASSEMBLY:	DOOR PANEL DETAILS

NO.	DATE	BY	REVISIONS

DATE:	8/10/16
SCALE:	N.T.S.
DWG. BY:	JK
CHK. BY:	LFS
DRAWING NO.:	FL-20800.6
SHEET	2 of 10

ALL WOOD DOOR COMPONENTS: SAPELE (G => 0.55)

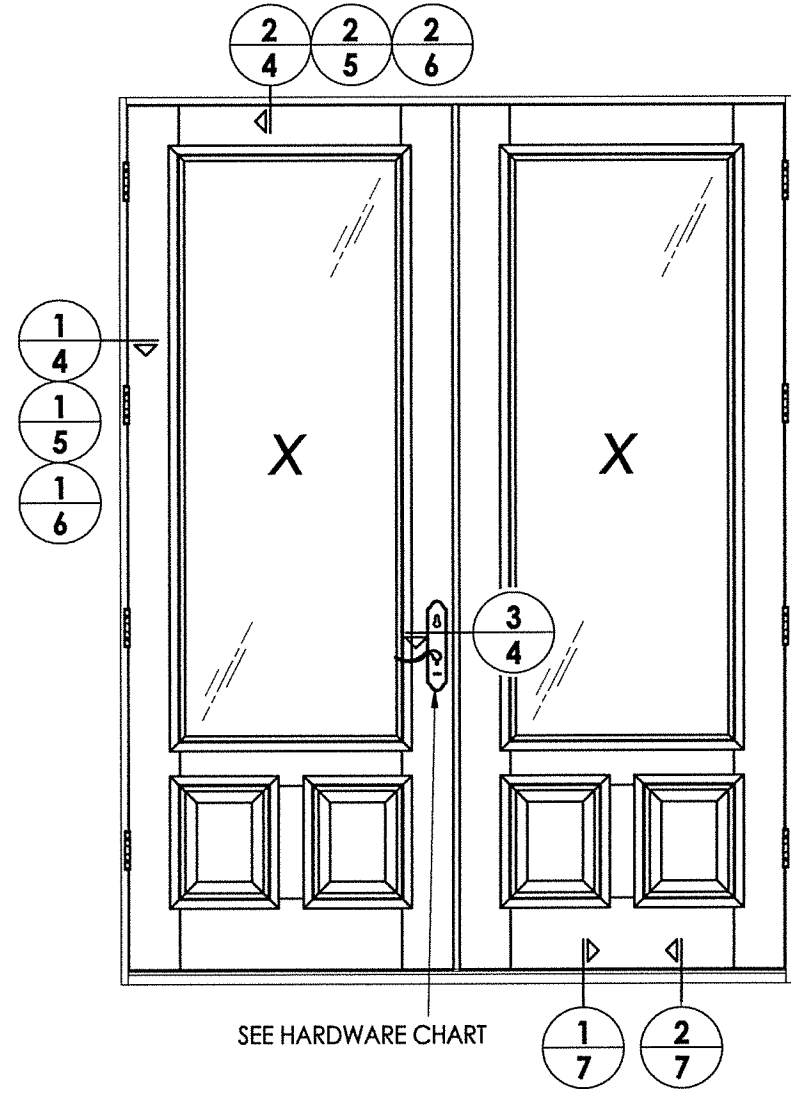

HARDWARE TABLE	
MANUFACTURER	MODEL
G-U	<b>ACTIVE DOOR</b> MULTIPOINT LOCK (3-pt Shootbolt): SECURY S-BOLT LOCKING SYSTEM (6-36928-01-0-8B) MORTISE LOCK TRIM: EMTEK
G-U	<b>INACTIVE DOOR</b> ASTRAGAL FLIP BOLT MORTISE LOCK (6-C7250-19-0-0)

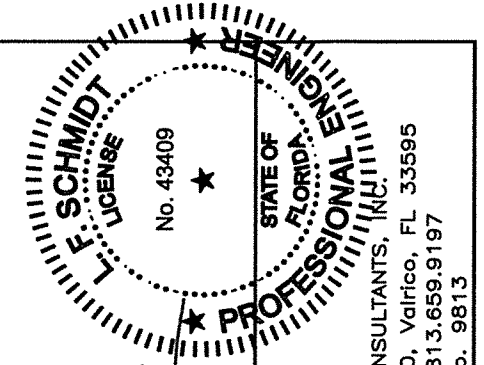

*LFS*  
8-24-16

Documents Prepared By:  
Lyndon F. Schmidt  
P.E. No. 43409

*RW* BUILDING CONSULTANTS, INC.  
P.O. Box 230, Valrico, FL 33595  
Phone No.: 813.659.9197  
FBPE C.A. No. 9813

PRODUCT: INTERNATIONAL WOOD TRADE WOOD DOOR  
PART OR ASSEMBLY: ELEVATIONS

NO.	DATE	BY	REVISIONS

DATE: 8/10/16  
SCALE: N.T.S.  
DWG. BY: JK  
CHK. BY: LFS  
DRAWING NO.: FL-20800.6  
SHEET 3 of 10





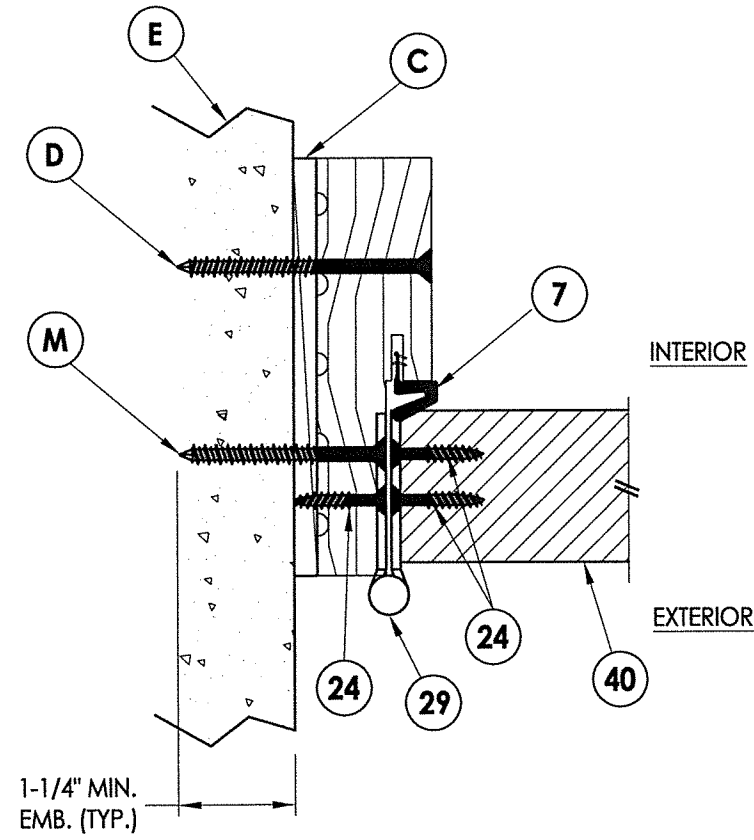

**1 HORIZONTAL CROSS SECTION**  
6 Shown Direct to Masonry  
Outswing only

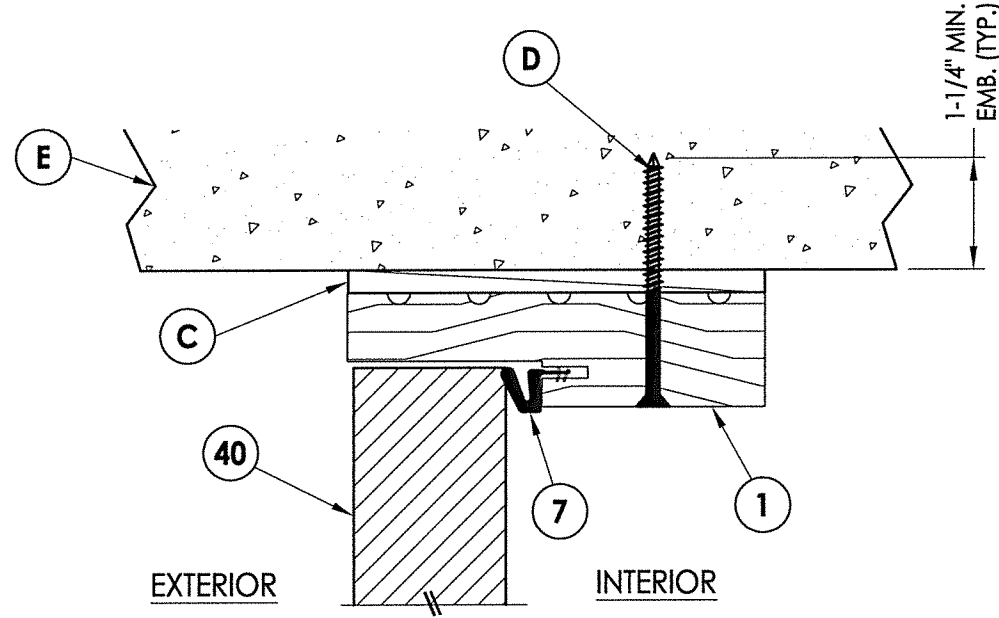

**2 VERTICAL CROSS SECTION**  
6 Shown Direct to Masonry  
Outswing only

DATE:	8/10/16
SCALE:	N.T.S.
DWG. BY:	JK
CHK. BY:	LFS
DRAWING NO.:	FL-20800.6
SHEET	6 OF 10

NO.	DATE	REVISIONS	BY

PRODUCT:  
INTERNATIONAL WOOD TRADE  
WOOD DOOR

PART OR ASSEMBLY:  
HORIZONTAL & VERTICAL CROSS  
SECTIONS (DIRECT TO MASONRY)

Documents Prepared By:  
Lyndon F. Schmidt  
P.E. No. 43409

**RW** BUILDING CONSULTANTS, INC.  
P.O. Box 230, Valrico, FL 33595  
Phone No.: 813.659.9197  
FBPE C.A. No. 9813

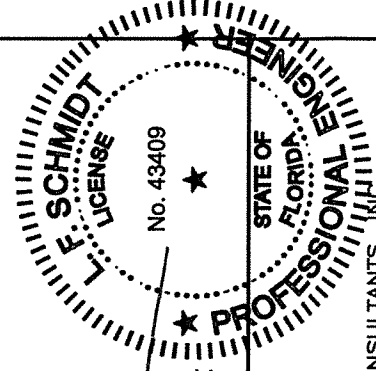

*LFS*  
8-28-16



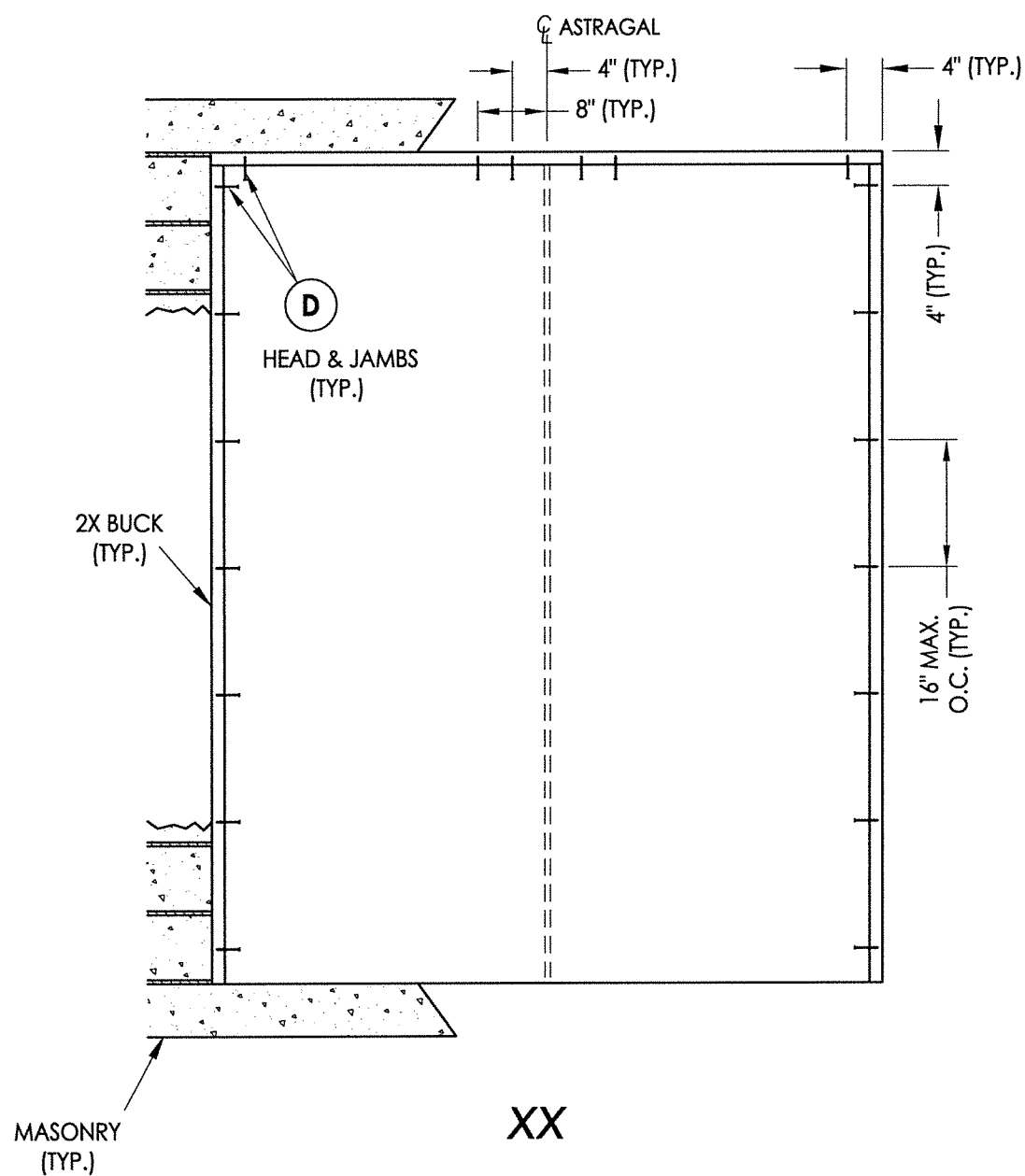

**2X BUCK ANCHORING**

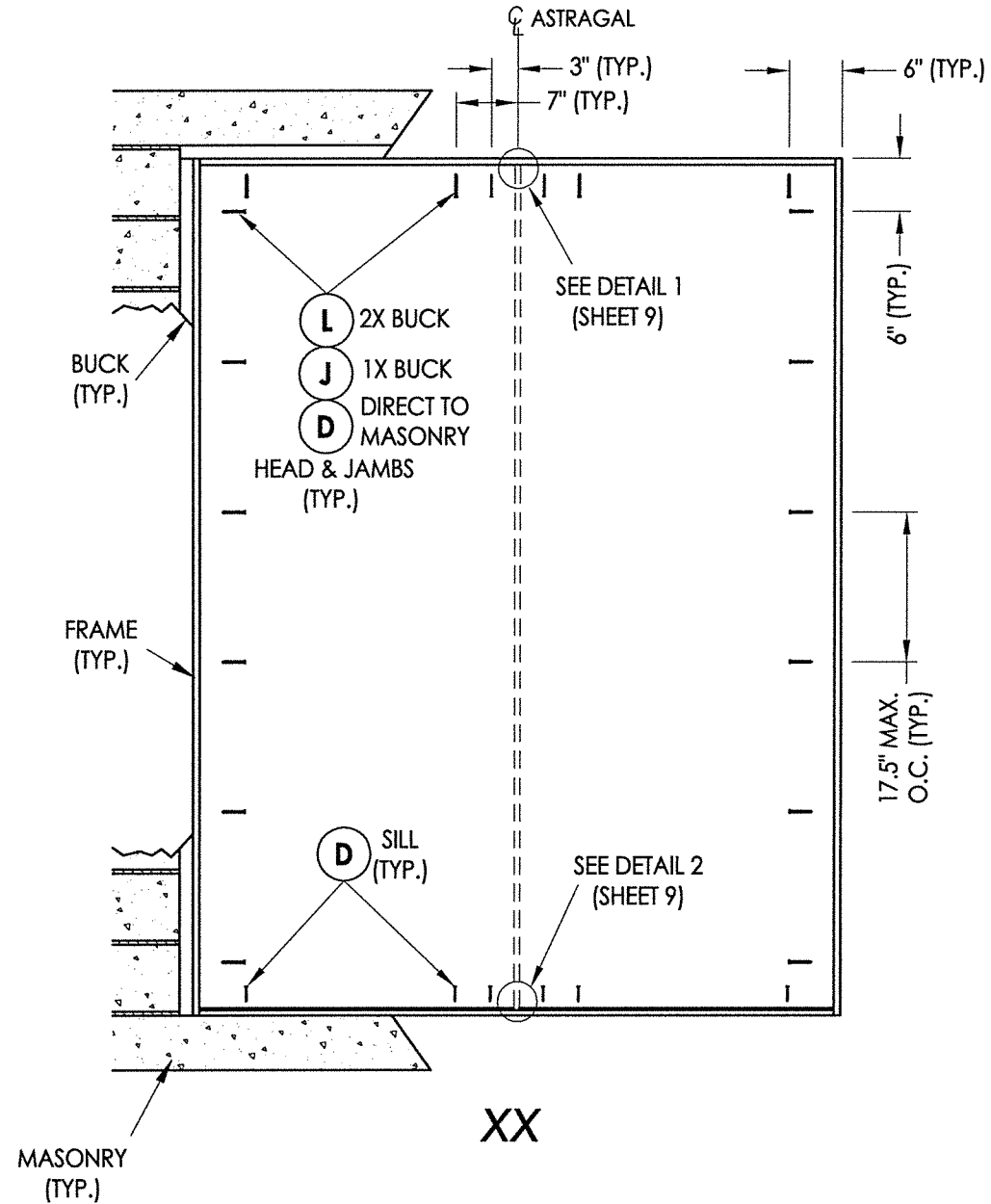

**FRAME ANCHORING**

NOTE:  
1. ALL FRAME CORNERS SECURED WITH (3) #8 X 3\"/>

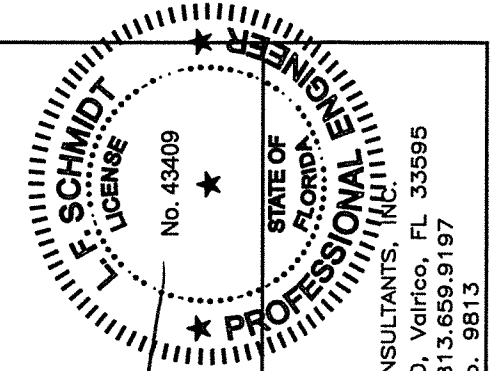

*LFS*  
8.24.16

Documents Prepared By:  
Lyndon F. Schmidt  
P.E. No. 43409

*RW* BUILDING CONSULTANTS, INC.  
P.O. Box 230, Vairico, FL 33595  
Phone No.: 813.659.9197  
FBPE C.A. No. 9813

PRODUCT:  
INTERNATIONAL WOOD TRADE  
WOOD DOOR

PART OR ASSEMBLY:  
BUCK ANCHORING

NO.	DATE	BY	REVISIONS

DATE: 8/10/16  
SCALE: N.T.S.  
DWG. BY: JK  
CHK. BY: LFS  
DRAWING NO.: FL-20800.6  
SHEET 8 OF 10



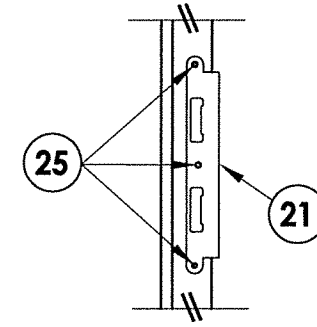
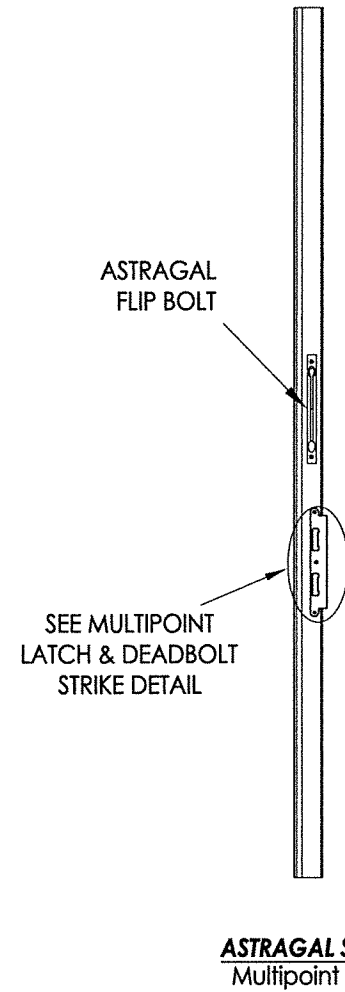
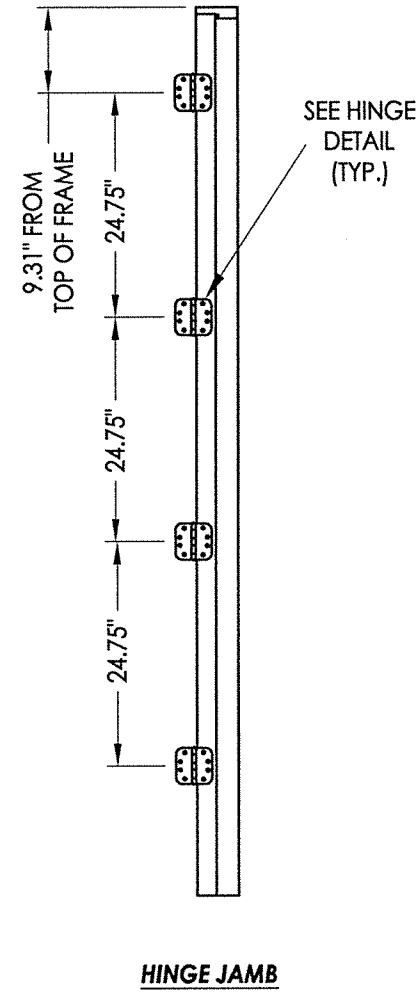
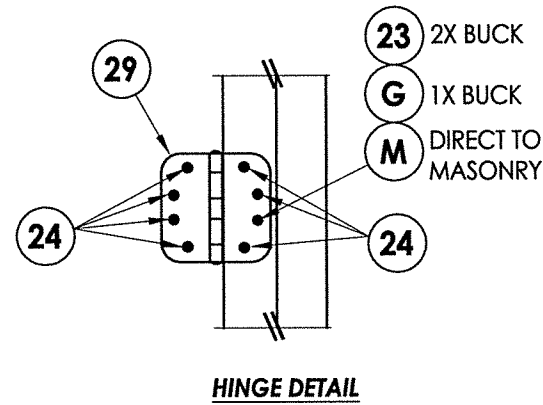

**MULTIPOINT LOCK HARDWARE DETAILS**

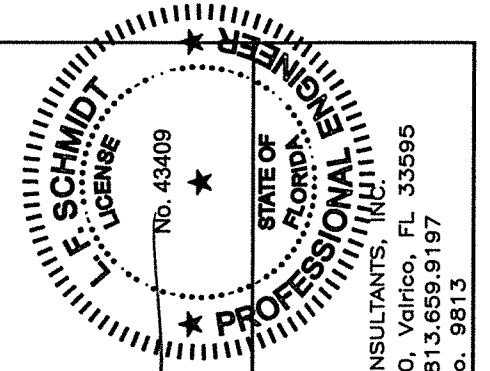
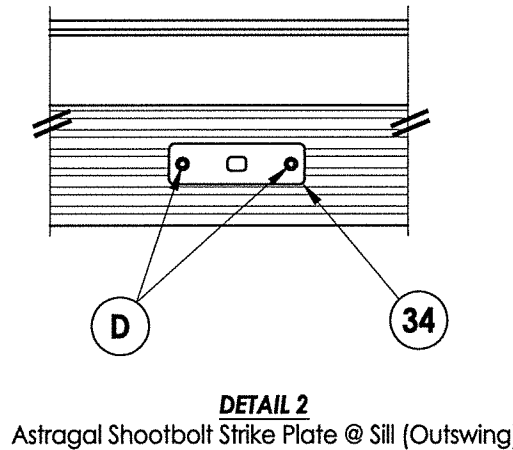
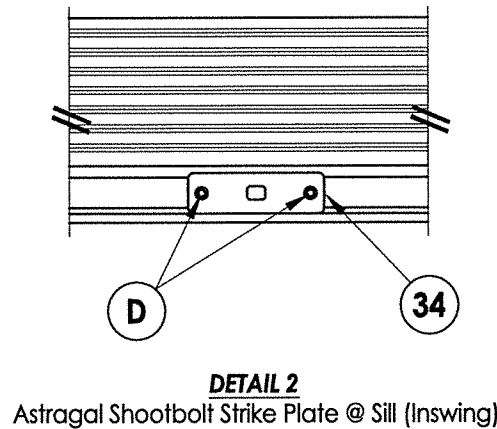
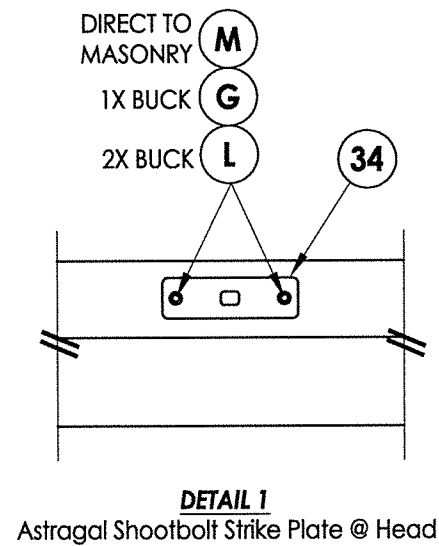

Documents Prepared By:  
Lyndon F. Schmidt  
P.E. No. 43409

R.W. BUILDING CONSULTANTS, INC.  
P.O. Box 230, Valrico, FL 33595  
Phone No.: 813.659.9197  
FBPE C.A. No. 9813

PRODUCT:	THERMA-TRU WOOD DOOR
PART OR ASSEMBLY:	HARDWARE DETAILS

NO.	DATE	BY	REVISIONS

DATE: 08/10/16  
SCALE: N.T.S.  
DWG. BY: JK  
CHK. BY: LFS  
DRAWING NO.: FL-20800.6  
SHEET 9 OF 10

